

MAX solutions

Mill-Max's Single-Row, Right-Angle Spring-Loaded Connectors

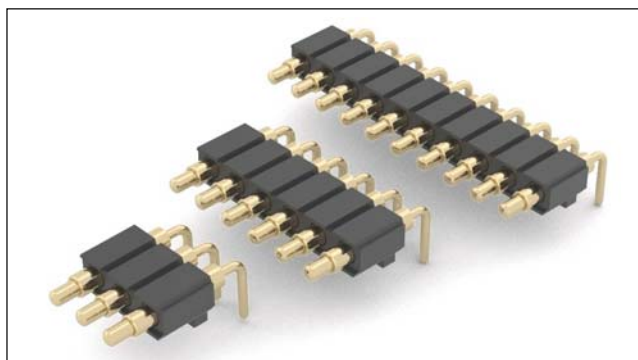

Mill-Max's 829 series single-row, right-angle strips are the perfect solution for applications calling for a spring-loaded connection that lies parallel to the pc board. Spring-loaded connectors (SLC) are commonly used to provide a high quality battery interface connection and in applications such as board-to-board interconnects and blind mate assemblies. This low profile, right angle connector is ideal for the small packaging requirements of hand-held devices, especially where vertical space is limited.

Offering all the superior characteristics of our other spring-loaded products, the 829 series has an increased mid-stroke distance of .045" (1.14 mm) – more than double most standard series product.

With tails bent at right-angles and locating pegs on the insulator, the 829 series is installed as a through-hole component providing a secure connection to the pc board.

These SLC's are suitable for hand, intrusive reflow or wave soldering.

Rated at 2A continuous, 3A peak per pin, the 829 series is offered in up to 10 positions in a strip.

For more information, please visit: www.mill-max.com/PR615.

(10/10 -- 615)

Mill-Max Mfg. Corp. • 190 Pine Hollow Road, Oyster Bay, NY 11771-0300
516-922-6000 • Fax: 516-922-9253 • www.mill-max.com





SPRING-LOADED CONNECTORS
Right Angle Mount
Single Row Strips

Series 829...001101

- Modular contacts for use on .100" grid, available in a height of .294", supplied in single contact strips.
- Precision-machined piston / base and gold plated components assure a 1,000,000 min. cycle life.
- Pistons have a .045" mid stroke and .090" max stroke.
- Low resistance, high current contacts are rated at 2 amps continuous, 3 amps peak.
- High temperature thermoplastic insulators are suitable for wave and reflow soldering processes.
- 829 series contact strips are designed for manual placement into $\varnothing .032 \pm .003$ " plated-thru-holes in the circuit board prior to hand, wave or reflow soldering.

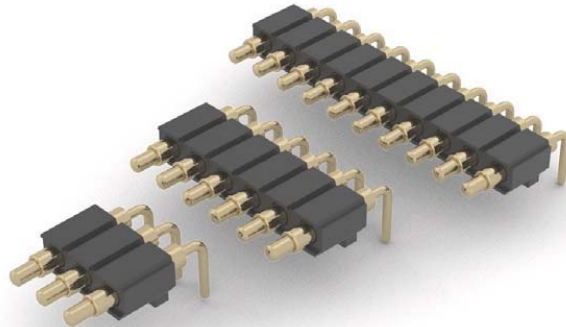

Single Row Series 829

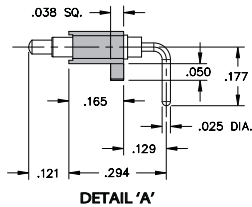
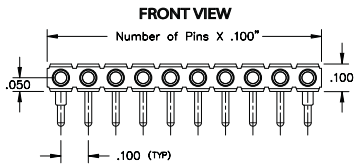
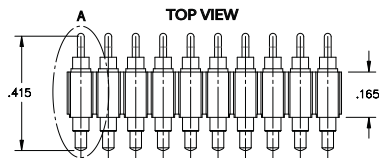
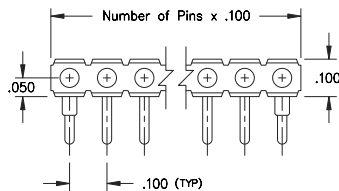

Suggested P.C.B Footprint

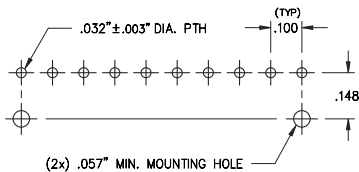

Ordering Information

Series 829

Single Row Right Angle

829-22-0__-20-001101

Specify # of pins

02-10

For Electrical, Mechanical & Environmental Data, See pg. 4.1

For RoHS compliance select \diamond plating code.

Technical Specifications

Materials:

Contact piston & Base: Machined copper alloy plated 20μ " gold over 100μ " nickel.

Spring: Beryllium copper plated 10μ " gold

Insulator: High temp. thermoplastic rated UL94 V-0

Mechanical:

Spring force @ initial height: 25 grams

Spring force @ mid stroke: 60 grams

Durability: 1,000,000 cycles min.

Electrical:

Voltage rating: 100Vrms/150Vdc

Current rating: 2A (continuous), 3A (peak) per contact

Contact resistance: $20m\Omega$ max.

Insulation resistance: 10,000M Ω min.

Dielectric strength: 700Vrms min.

Capacitance: 1pF max.

