

High power contact
for solder pin angled

Plug

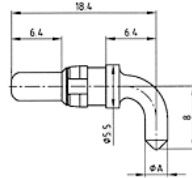

Socket

Plug premating

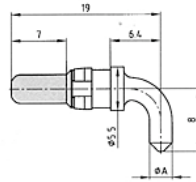
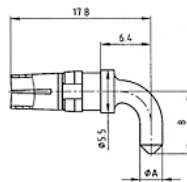

Note: Premating contacts factory installed, please consult factory.

Current Rating	øA
20 A	2,90
40 A	3,80

Part Numbers

Current Rating	Quality Class 1				Quality Class 3		
	Socket contact	Termination type	Plug contact	Plug premating	Socket contact	Termination type	Plug contact
20 A	124 C 13019 X	21	123 C 13019 X	123 C 13119 X	124 A 13019 X	16	123 A 13019 X
40 A	124 C 13039 X	23	123 C 13039 X	123 C 13139 X	124 A 13039 X	15	123 A 13039 X

Quality Class 1 = C = 30 micro inch gold plating mating side
Quality Class 3 = A = hard gold plated